

# 106 Series Surface Mount

A01 - Floor to Floor

A02 - Floor to Wall

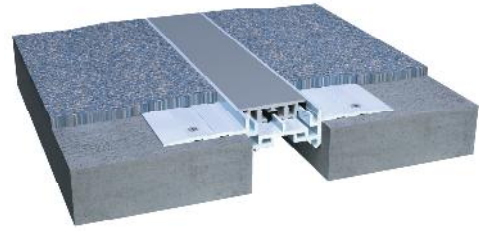

**Movement Rating ± 25%**

## Product Guide



Thermal



Interior



Fire Rated Option



Vapor Barrier Option

- ▶ Dual durometer seal provides secure fit and optimal flexibility
  - ▶ Seals absorb limited serviceable seismic movement
  - ▶ Designed for renovation and surface mount installations
  - ▶ Adaptable to concrete, epoxy, vinyl and caret finishes
  - ▶ Seamlessly integrates with the following wall and ceiling systems
  - ▶ Easy to clean flush seals. No dirt or water traps
  - ▶ Snap-fit design for easy on site assembly
  - ▶ Mill finish aluminum
- ▶ Standard seal colors: black, beige, gray, off white and bright white. Custom colors available upon request.

| Application    | System      | W           |    | H1             |    | H2       |    | S         |    | B        |    | Movement +/- |    |          |    |
|----------------|-------------|-------------|----|----------------|----|----------|----|-----------|----|----------|----|--------------|----|----------|----|
|                |             | Joint Width |    | Frame Height 1 |    | Height 2 |    | Sightline |    | Blockout |    | Horizontal   |    | Vertical |    |
|                |             | US          | mm | US             | mm | US       | mm | US        | mm | US       | mm | US           | mm | US       | mm |
| Floor to Floor | 106-A01-025 | 1"          | 25 | 5/8"           | 16 | 1/4"     | 6  | 1"        | 25 | *        | *  | 1/4"         | 6  | 1/4"     | 6  |
|                | 106-A01-038 | 1 1/2"      | 38 | 5/8"           | 16 | 1/4"     | 6  | 1 1/2"    | 36 | *        | *  | 3/8"         | 10 | 3/8"     | 10 |
|                | 106-A01-050 | 2"          | 51 | 1"             | 25 | 1/4"     | 6  | 2"        | 47 | *        | *  | 1/2"         | 13 | 1/2"     | 13 |
|                | 106-A01-075 | 3"          | 76 | 1 1/8"         | 28 | 1/4"     | 6  | 3"        | 73 | *        | *  | 3/4"         | 19 | 3/4"     | 19 |
| Floor to Wall  | 106-A02-025 | 1"          | 25 | 5/8"           | 16 | 1/4"     | 6  | 1"        | 25 | *        | *  | 1/4"         | 6  | 1/4"     | 6  |
|                | 106-A02-038 | 1 1/2"      | 38 | 5/8"           | 16 | 1/4"     | 6  | 1 1/2"    | 36 | *        | *  | 3/8"         | 10 | 3/8"     | 10 |
|                | 106-A02-050 | 2"          | 51 | 1"             | 25 | 1/4"     | 6  | 2"        | 47 | *        | *  | 1/2"         | 13 | 1/2"     | 13 |
|                | 106-A02-075 | 3"          | 76 | 1 1/8"         | 28 | 1/4"     | 6  | 3"        | 73 | *        | *  | 3/4"         | 19 | 3/4"     | 19 |

IPC.653/REV.4

Inprocorp.com • 800.222.5556 • 262.679.9010  
 World Headquarters S80 W18766 Apollo Drive, Muskego, WI 53150 USA

**JOINTMASTER®**  
 EXPANSION JOINT SYSTEMS  
 A DIVISION OF INFRO®

# 106 Series

## Surface Mount Floor Systems

106-A01 Floor/Floor for Carpet  
(2" (50mm) system shown)

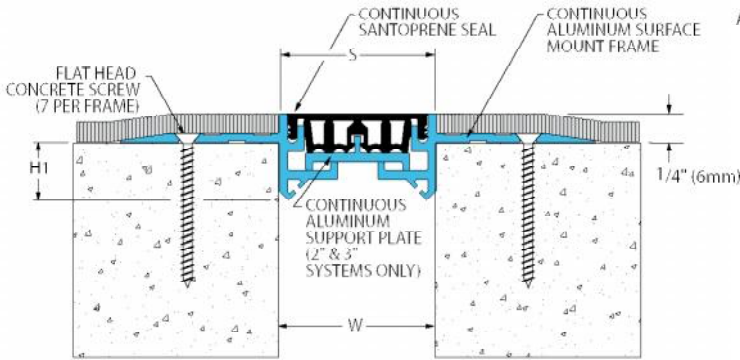

106-A02 Floor/Floor for Carpet  
(2" (50mm) system shown)

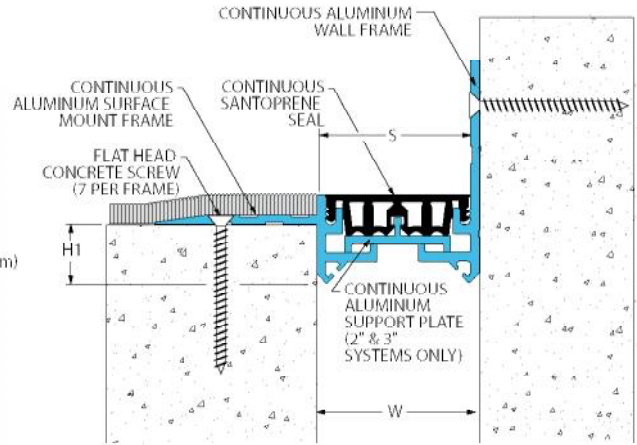

# 106 Series

## Options

Fire Mineral Wool & Sealant Fire Barrier System  
(106-A01-025 system shown)

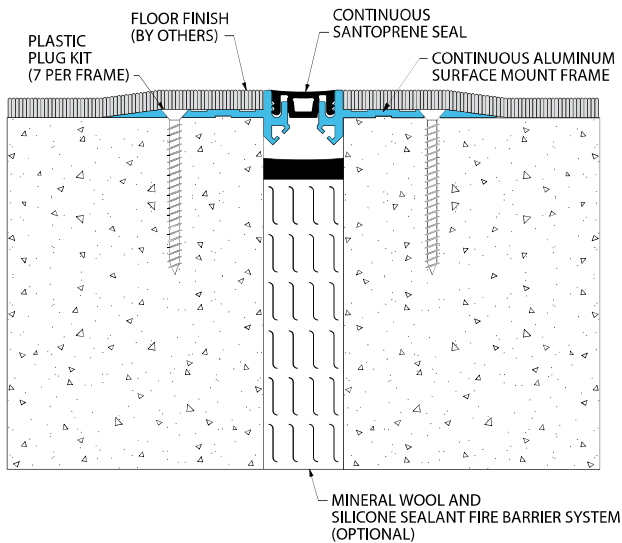

Vapor Barrier System  
(106-A01-50 system shown)

