

# Installation Instructions

## 1500i/1500iW/G2-1500i Wall Guard

Please read all instructions before installing wallguard.

### Important

1. Acclimate materials 24 hrs before installation. Maintain temperature controlled environment after installation.
2. Install in accordance with manufacturer's installation instructions. Failure to do so will void the warranty.

### Installation tips

1. Cut covers up to 1/16" (1.6mm) longer to ensure a tight fit.
2. Lubricate blades when cutting aluminum to reduce burrs.

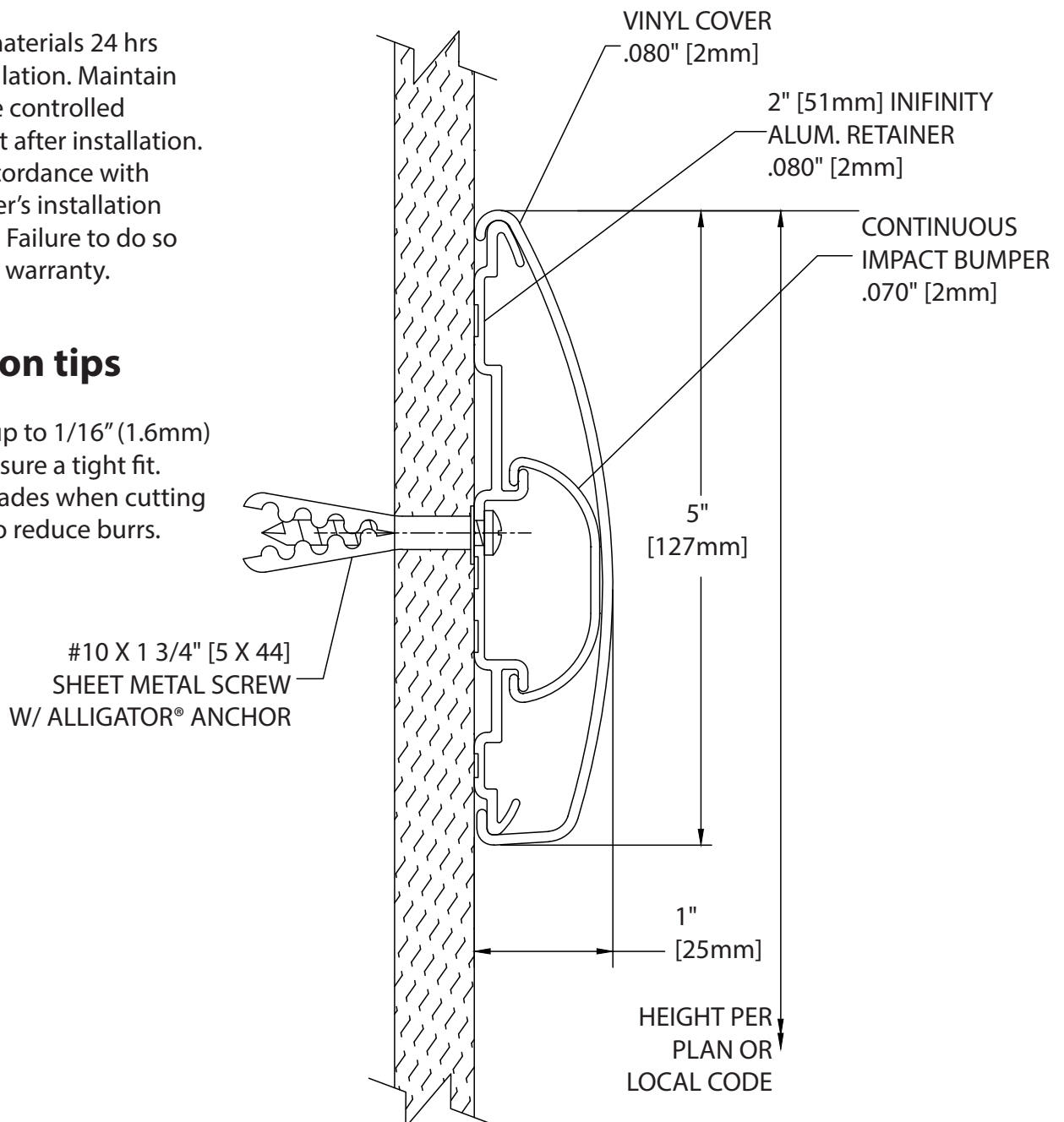

### Recommended tools

Safety Glasses, Tape Measure, Level, Phillips and Flat head Screwdrivers, Power Drill, Drill Bits - 1/4" masonry (concrete/concrete block), Power Miter Saw, 10" Blade with 60-80 Carbide Tipped Teeth.

IPC.425/REV.10

IPC® Door + Wall Protection

inpro.com • 800.222.5556 • 262.679.9010

World Headquarters S80 W18766 Apollo Drive, Muskego, WI 53150 USA

Installation Hotline: 866.394.6776

**inpro**®

# Installation Instructions

## 1500i/1500iW/G2-1500i Wall Guard

Please read all instructions before installing wallguard.

### PARTS

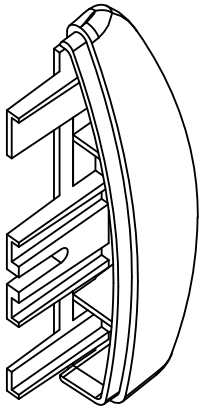

1501R  
RIGHT END CAP

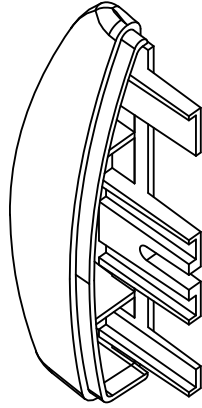

1501L  
LEFT END CAP

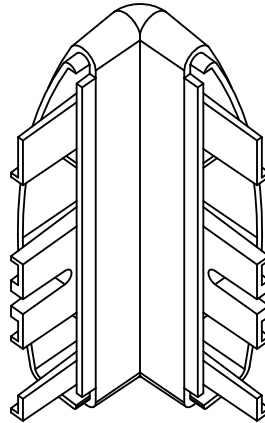

1502  
OUTSIDE CORNER

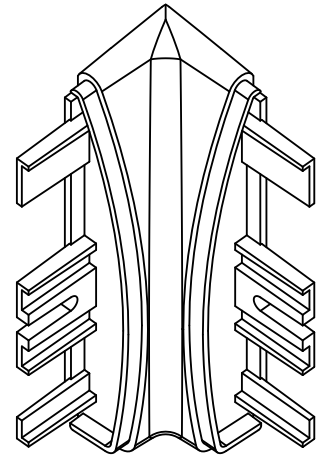

1503  
INSIDE CORNER



1500V  
COVER



1500AI  
2" ALUMINUM  
INFINITY RETAINER



1500RVL  
REVEAL

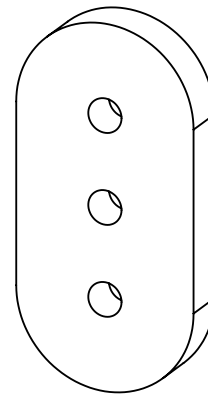

1601  
(OPTIONAL)  
RUBBER  
SPACER

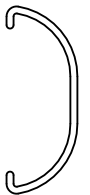

1400B  
IMPACT BUMPER

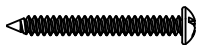

#10 X 1 3/4" [5 X 44]  
SHEET METAL SCREW



#8 X 1 1/2" [4 X 38]  
PHILLIPS INDENTED  
HEX WASHER SELF-  
DRILLING SCREW

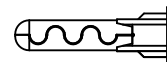

ALLIGATOR  
ANCHOR

Wall Condition	Specified Fasteners	Inpro Part #
Profile Hardware Kit	#10 x 1 3/4" PHILLIPS PAN SHEET METAL SCREW W/ ALLIGATOR ANCHOR	HWK-WG

IPC® Door + Wall Protection

inpro.com • 800.222.5556 • 262.679.9010

World Headquarters S80 W18766 Apollo Drive, Muskego, WI 53150 USA

Installation Hotline: 866.394.6776

**inpro**®

# Installation Instructions

## 1500i/1500iW/G2-1500i Wall Guard

Please read all instructions before installing wallguard.

### LAYOUT VIEWS

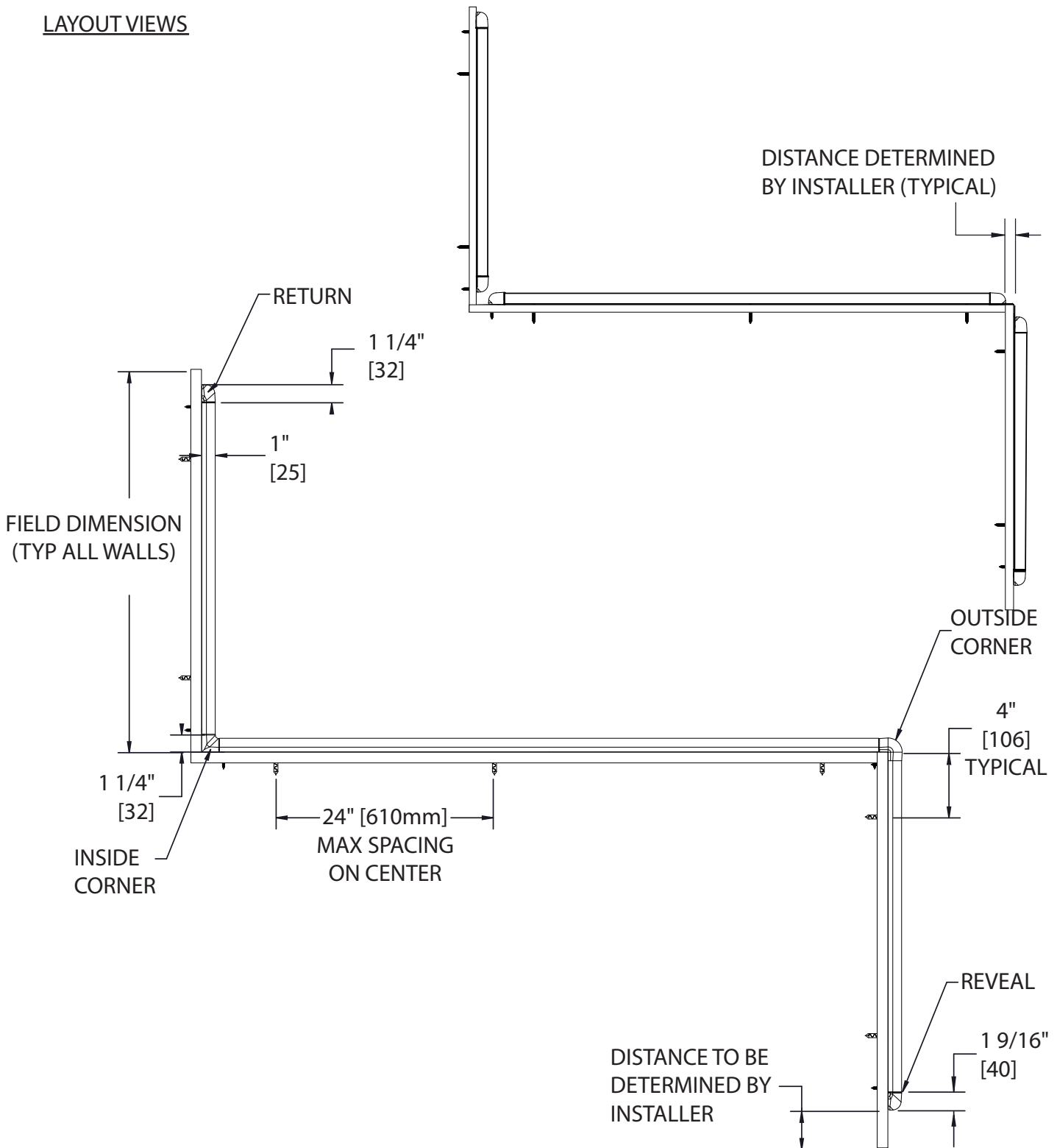

IPC® Door + Wall Protection

inpro.com • 800.222.5556 • 262.679.9010

World Headquarters S80 W18766 Apollo Drive, Muskego, WI 53150 USA

Installation Hotline: 866.394.6776

**inpro**®

# Installation Instructions

## 1500i/1500iW/G2-1500i Wall Guard

Please read all instructions before installing wallguard.

### EXPLODED VIEW

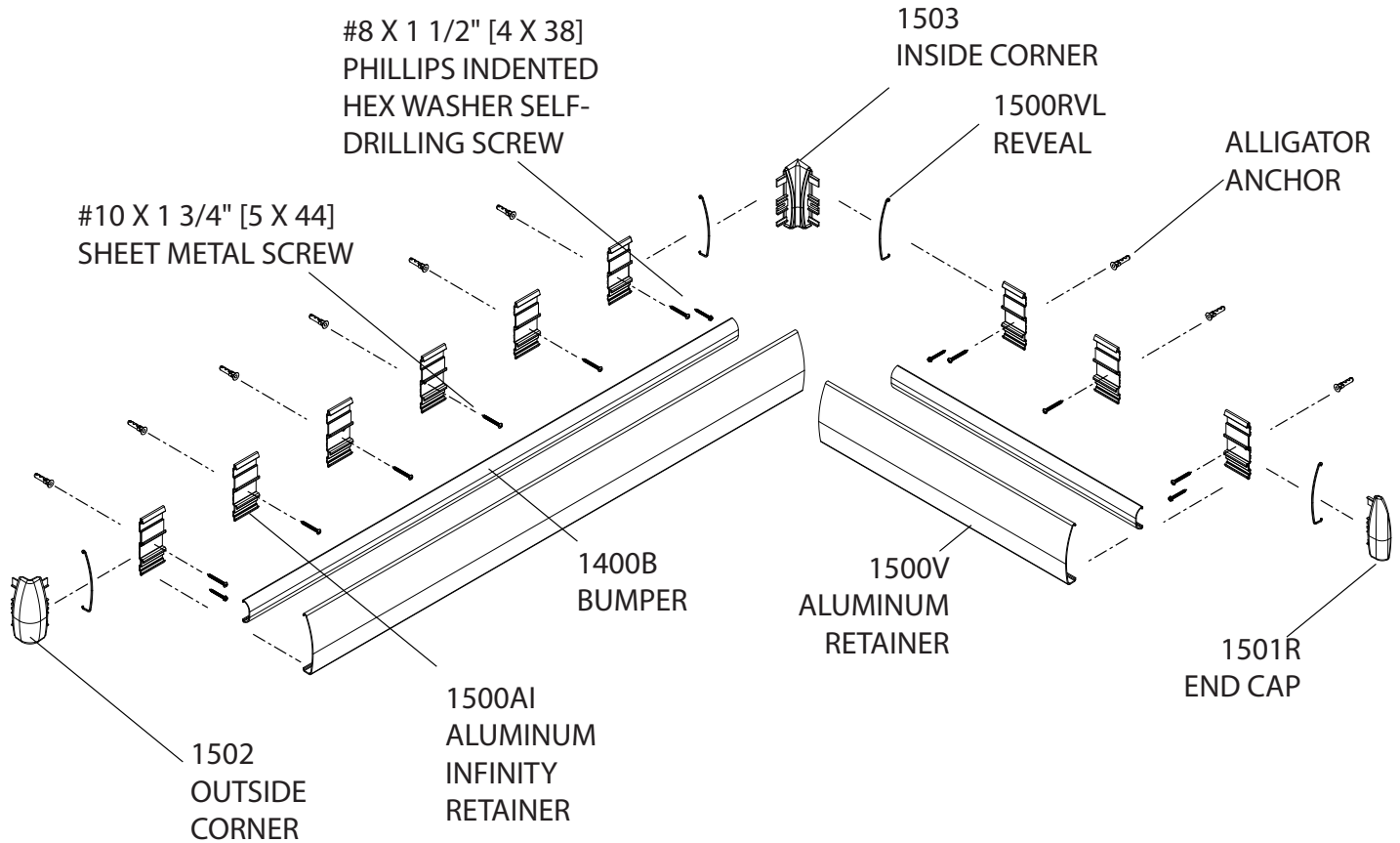

IPC® Door + Wall Protection

inpro.com • 800.222.5556 • 262.679.9010

World Headquarters S80 W18766 Apollo Drive, Muskego, WI 53150 USA

Installation Hotline: 866.394.6776

**inpro**®

# Installation Instructions

## 1500i/1500iW/G2-1500i Wall Guard

Please read all instructions before installing wallguard.

FIG. 1

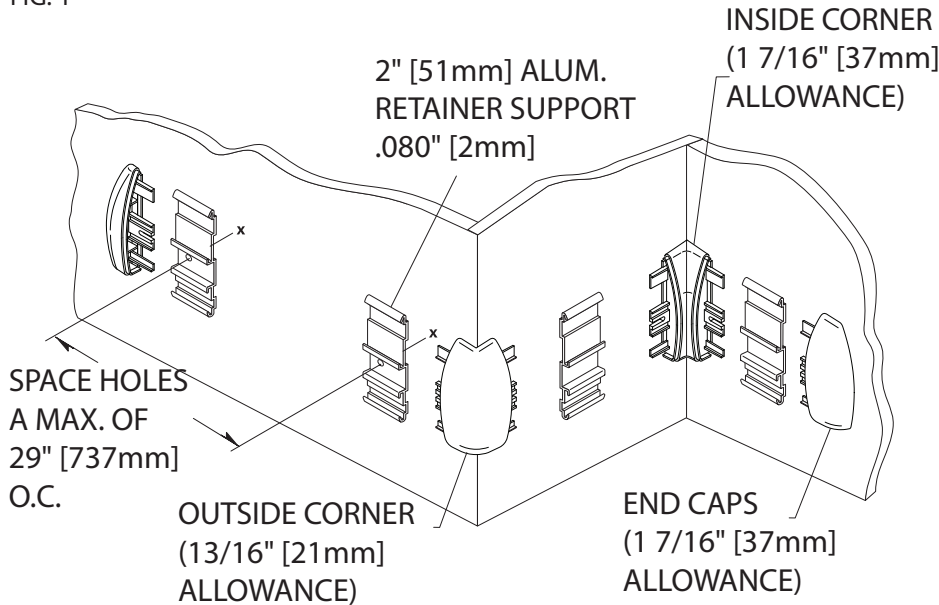

1. Determine height of wall guard on wall. Measure down 2 1/2" [64mm] and snap chalk line. Mark mounting holes leaving allowance for returns, outside corners and inside corners. See Figure 1.

FIG. 2

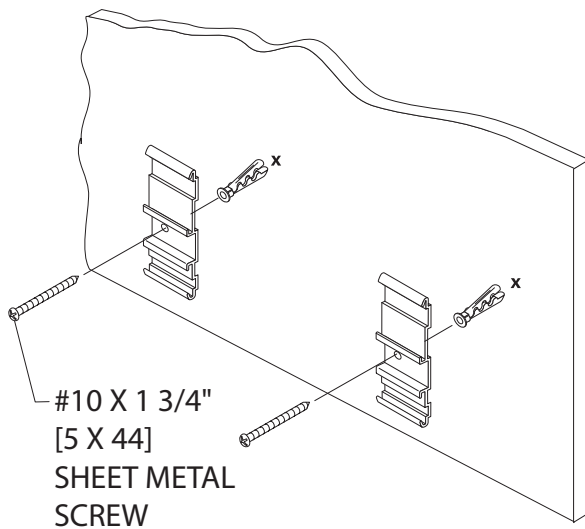

2. Drill marked holes on wall using a 1/4" [6mm] drill bit and position Alligator anchors into holes. Mount retainer supports on wall and tighten screws to secure. NOTE: For concrete or brick wall installation, drill 1/4" [6mm] holes, 3/8" [10mm] from end of retainer for end caps/corners. See Figure 2.

# Installation Instructions

## 1500i/1500iW/G2-1500i Wall Guard

Please read all instructions before installing wallguard.

FIG. 3

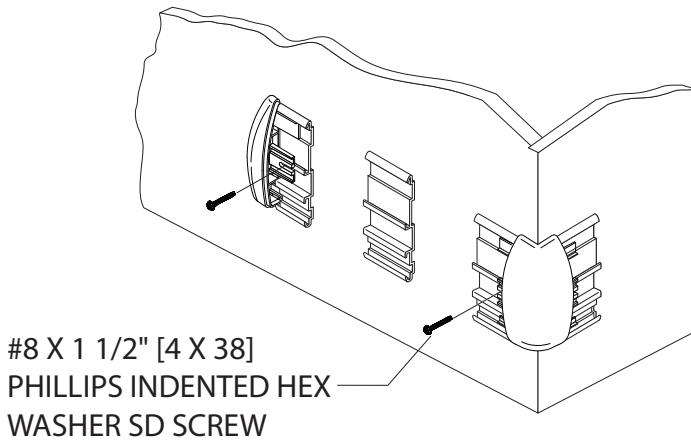

- Slide end caps and corners onto the retainer support and secure, leaving a 1/16" [1.5mm] gap between returns/corners and retainer to allow for adjustment.

See Figure 3.

NOTE: For concrete or brick wall installation, use #10 x 1 3/4" [5 x 44mm] Phillips screws to secure end caps and corners.

FIG. 4

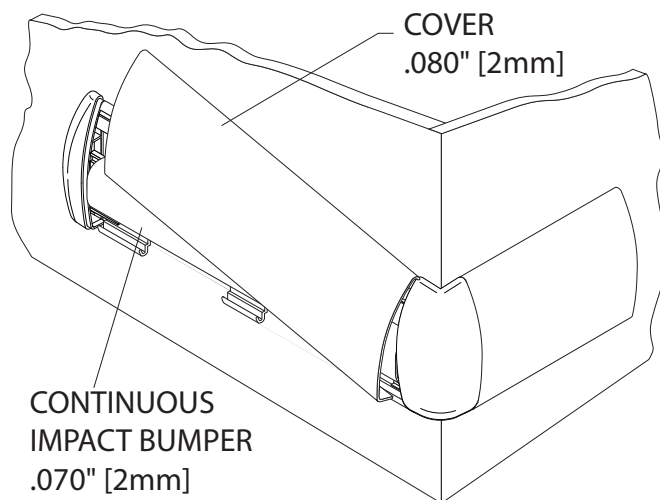

- Cut the impact bumper to the length between the inside edge of the end caps/corners. Position and snap bumper in place. Cut the cover to length between end caps and/or corners. (Note: Trim factory edges square before installation). Position cover on retainer and adjust returns and/or corners for a tight fit. Starting at one end of retainer supports, push cover over the retainer supports until it snaps into place. See Figure 4.