

611 Series

A07 - Wall to Wall or Ceiling to Ceiling

A09 - Wall to Corner or Wall to Ceiling

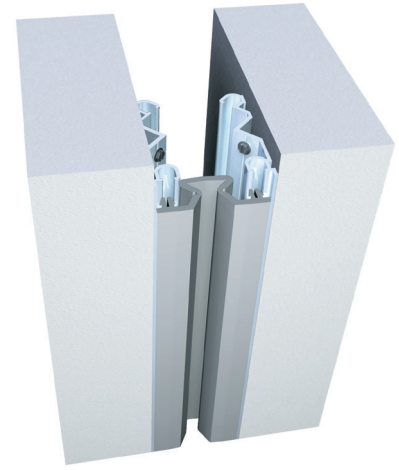

Movement Rating ± 50%

Product Guide



Seismic



Exterior



Interior



Fire Rated Option



Vapor Barrier Option

- ▶ Flush mount interior and exterior systems reduce sightline
- ▶ Santoprene® seals - Field heat weldable for weather tight transitions
- ▶ Standard seal colors: black, beige, gray, off white and bright white. Custom colors available upon request
- ▶ System does not include backseal
- ▶ May be installed to various substrates with mechanical anchors or epoxy adhesive

| Application | System | W | | H1 | | H2 | | S | | B | | Movement +/- | | | |
|------------------------------|-------------|-------------|-----|----------------|----|----------|----|-----------|-----|----------|----|--------------|----|----------|----|
| | | Joint Width | | Frame Height 1 | | Height 2 | | Sightline | | Blockout | | Horizontal | | Vertical | |
| | | US | mm | US | mm | US | mm | US | mm | US | mm | US | mm | US | mm |
| Wall/Wall Ceiling/Ceiling | 611-A07-050 | 2" | 51 | 2 7/16" | 61 | * | * | 2" | 51 | * | * | 1" | 25 | 1" | 25 |
| | 611-A07-075 | 3" | 76 | 2 7/16" | 61 | * | * | 3" | 76 | * | * | 1 1/2" | 38 | 1 1/2" | 38 |
| | 611-A07-100 | 4" | 102 | 2 7/16" | 61 | * | * | 4" | 102 | * | * | 2" | 51 | 2" | 51 |
| | 611-A07-125 | 5" | 127 | 2 7/16" | 61 | * | * | 5" | 127 | * | * | 2 1/2" | 63 | 2 1/2" | 63 |
| | 611-A07-150 | 6" | 152 | 2 7/16" | 61 | * | * | 6" | 152 | * | * | 3" | 76 | 3" | 76 |
| Wall/Corner Wall/Ceiling | 611-A09-050 | 2" | 51 | 2 7/16" | 61 | * | * | 2" | 51 | * | * | 1" | 25 | 1" | 25 |
| | 611-A09-075 | 3" | 76 | 2 7/16" | 61 | * | * | 3" | 76 | * | * | 1 1/2" | 38 | 1 1/2" | 38 |
| | 611-A09-100 | 4" | 102 | 2 7/16" | 61 | * | * | 4" | 102 | * | * | 2" | 51 | 2" | 51 |
| | 611-A09-125 | 5" | 127 | 2 7/16" | 61 | * | * | 5" | 127 | * | * | 2 1/2" | 63 | 2 1/2" | 63 |
| | 611-A09-150 | 6" | 152 | 2 7/16" | 61 | * | * | 6" | 152 | * | * | 3" | 76 | 3" | 76 |

IPC.858/REV.16

611 Series

Flush Mount Wall and Ceiling Systems

611-A07 Wall/Wall Ceiling/Ceiling
(3" (75mm) system shown)

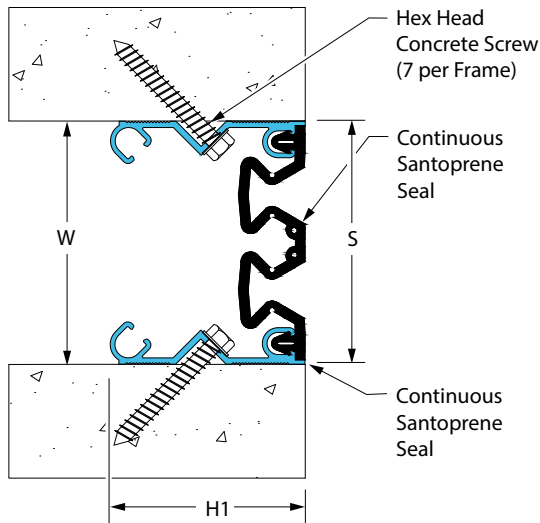

611-A09 Wall/Corner Wall/Ceiling
(2" (50mm) system shown)

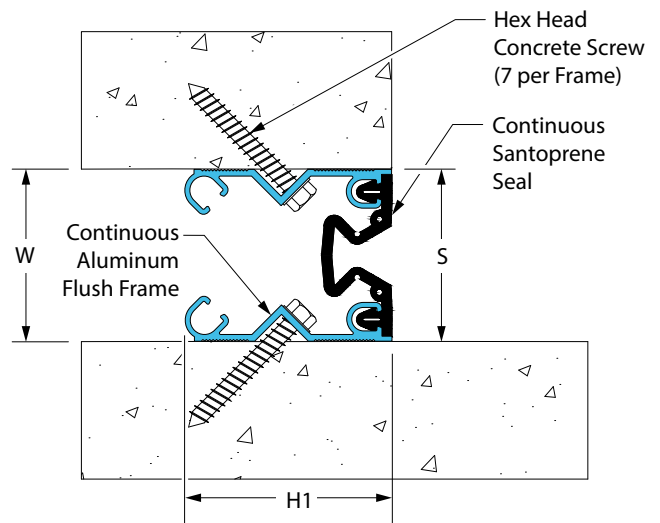

611 Series Options

611-A07 Wall/Wall Ceiling/Ceiling
(3" (75mm) system shown)

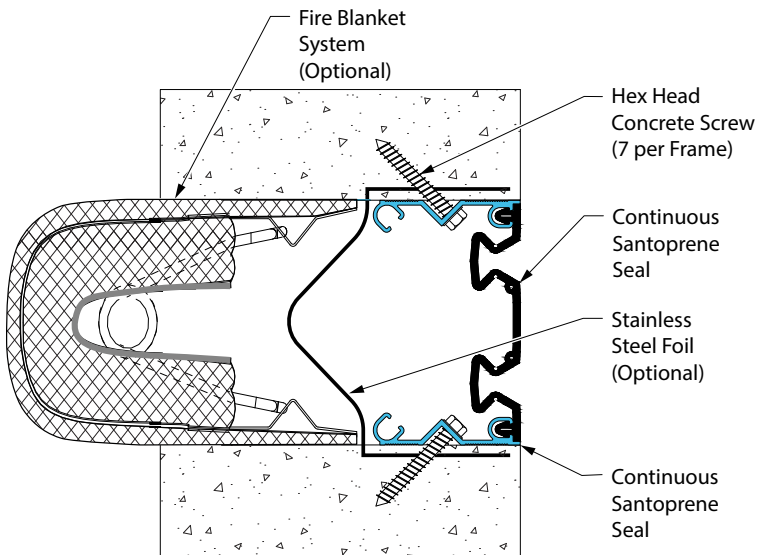

611-A09 Wall/Corner Wall/Ceiling
(2" (50mm) system shown)

