

# 806SD Series

A01 - Floor to Floor

A02 - Floor to Wall



Movement Rating  $\pm 50\%$

Product  
Guide



Thermal



Exterior



Interior



Fire Rated  
Option



Vapor



ADA  
Compliant

- ▶ Surface mount cover applicable to renovations, additions and new construction
- ▶ Pre-drilled countersunk holes for easy installation
- ▶ Hinged plates allow system to accommodate uneven slabs and deck deflection
- ▶ Provided with a adhered, tough, sound damping pads for noise reduction on hard flooring
- ▶ Applicable to Moderate loading conditions
- ▶ Mill finish standard with serrations for slip resistance

Application	System	W		H1		S		Movement +/-			
		Joint Width		Frame Height 1		Sightline		Horizontal (+/-)		Vertical (+/-)	
		US	mm	US	mm	US	mm	US	mm	US	mm
Floor to Floor	806SD-A01-050	2"	51	1/4"	7	7"	178	$\pm 1"$	$\pm 25$	+1/4" / -1"	+6 / -25
	806SD-A01-100	4"	102	1/4"	7	10 1/2"	267	$\pm 2"$	$\pm 51$	+5/8" / -2"	+10 / -51
	806SD-A01-150	6"	152	1/4"	7	13"	330	$\pm 3"$	$\pm 76$	+7/8" / -2 3/4"	+13 / -71
	806SD-A01-200	8"	203	7/16"	12	17 11/16"	449	$\pm 4"$	$\pm 102$	+1" / -2 1/2"	+25 / -64
	806SD-A01-250	10"	254	1/2"	12	19 3/4"	502	$\pm 5"$	$\pm 127$	+1 3/8" / -3"	+35 / -76
	806SD-A01-300	12"	305	9/16"	14	23 1/16"	586	$\pm 6"$	$\pm 152$	+1 5/8" / -3 1/2"	+41 / -90
Floor to Wall	806SD-A02-050	2"	51	1/4"	7	4"	102	$\pm 1"$	$\pm 25$	+1/4" / -1"	+6 / -25
	806SD-A02-100	4"	102	1/4"	7	7 1/2"	191	$\pm 2"$	$\pm 50$	+5/8" / -2"	+10 / -51
	806SD-A02-150	6"	152	1/4"	7	10"	254	$\pm 3"$	$\pm 76$	+7/8" / -2 3/4"	+13 / -71
	806SD-A02-200	8"	203	7/16"	12	13 5/8"	346	$\pm 4"$	$\pm 100$	+1" / -2 1/2"	+25 / -64
	806SD-A02-250	10"	254	1/2"	12	15 5/8"	398	$\pm 5"$	$\pm 125$	+1 3/8" / -3"	+35 / -76
	806SD-A02-300	12"	305	9/16"	15	19"	482	$\pm 6"$	$\pm 150$	+1 5/8" / -3 1/2"	+41 / -90

IPC.1010/REV.8

# 806SD Series

Sound Dampened Cover Plate System

806SD-A01 Floor/Floor  
(2" (51mm) system shown)

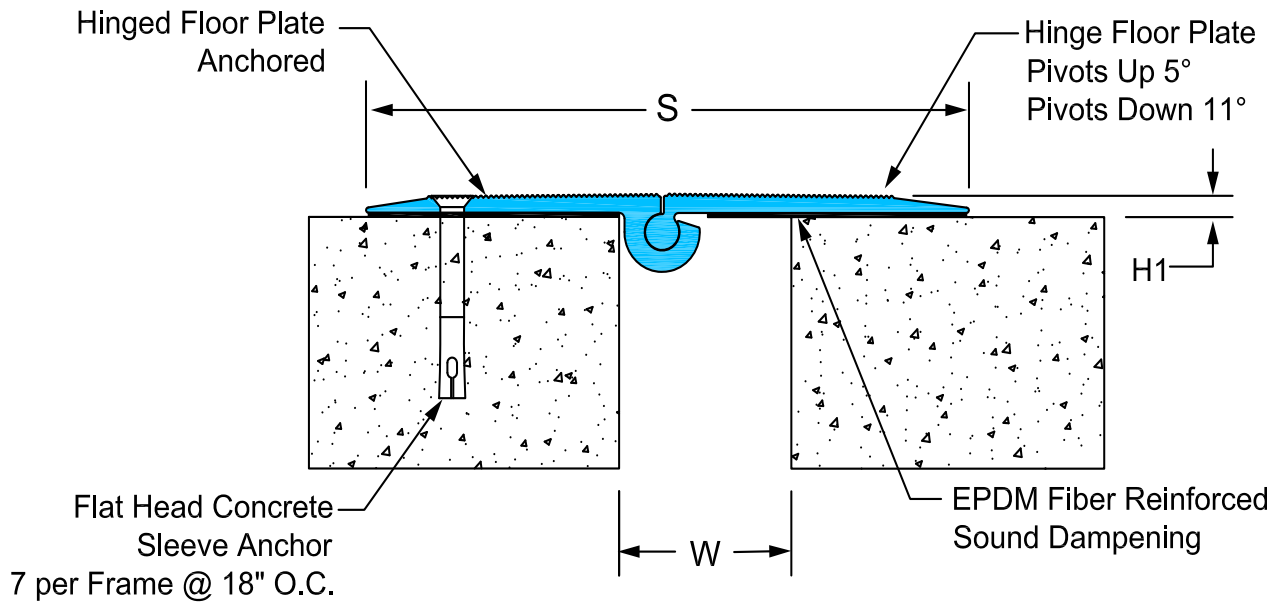

806SD-A02 Floor/Wall  
(2" (51mm) system shown)

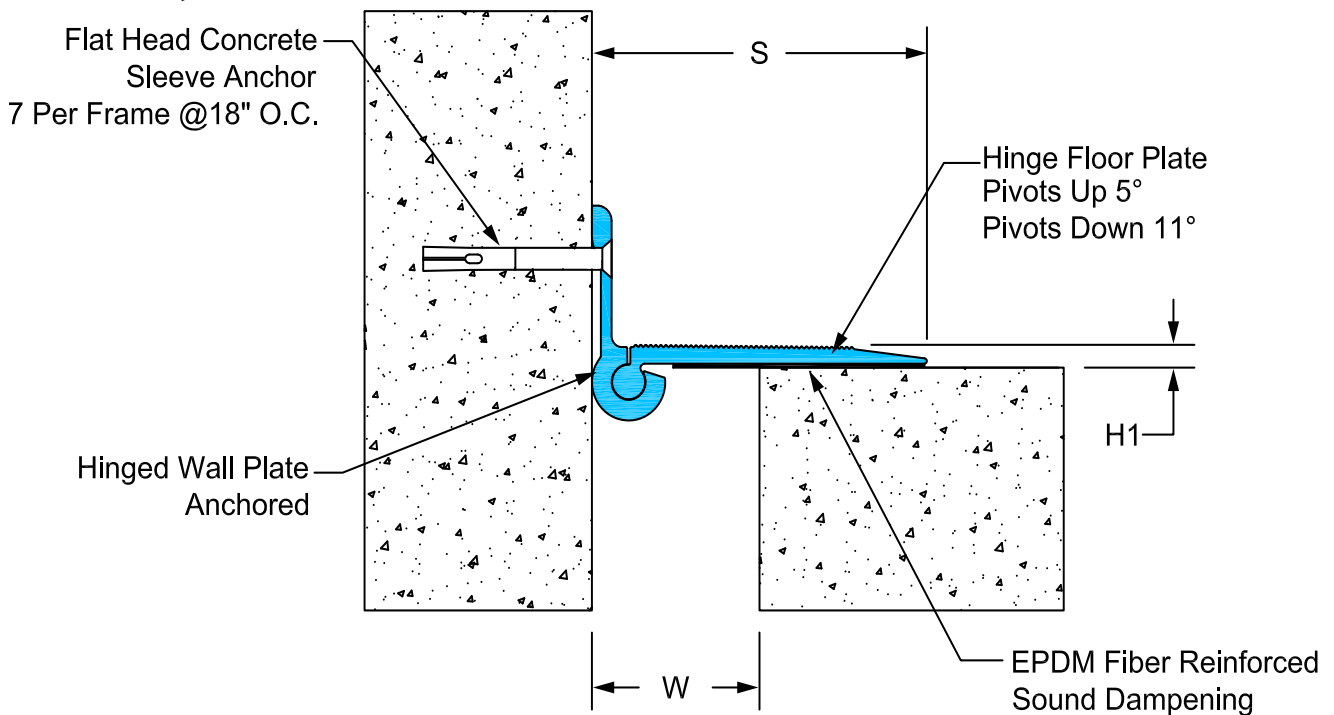

# 806SD Series

## Options

806SD-A01 Floor/Floor With Fire Barrier  
(2" (51mm) system shown)

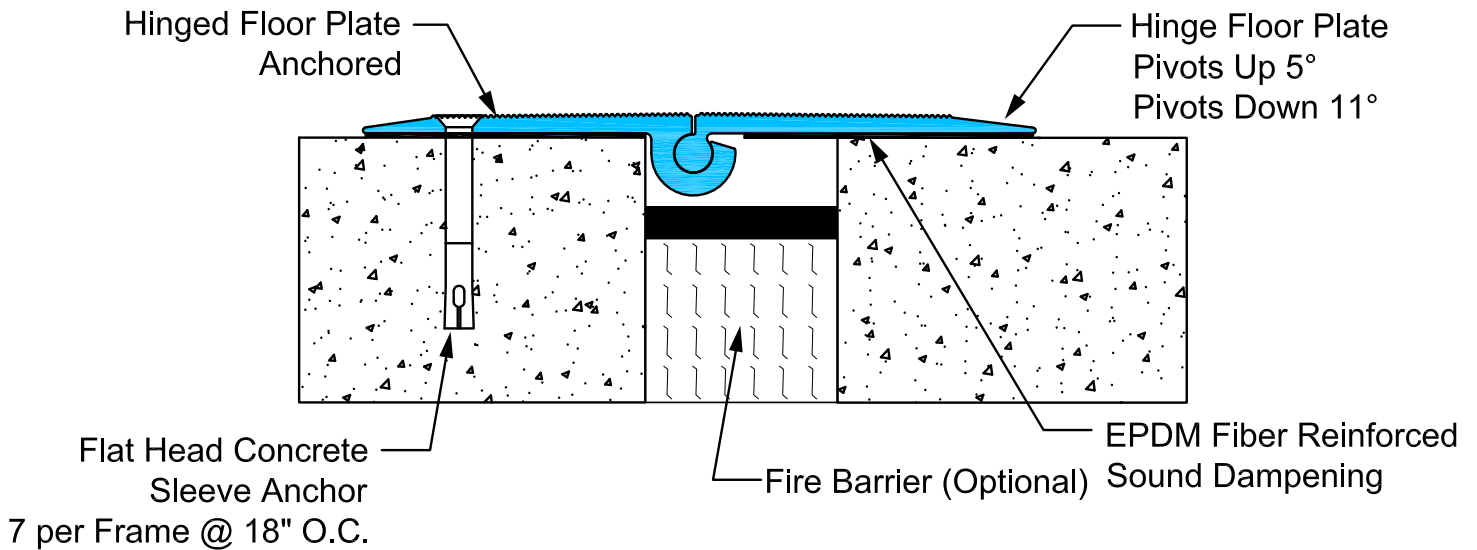

806SD-A01 Floor/Floor With Vapor Barrier  
(2" (51mm) system shown)

