

BLOCKOUT DIM NOTE:
 BLOCKOUT DIMENSION PROVIDED ARE RECOMMENDED MINIMUM DIMENSIONS AND RELATE DIRECTLY TO HEADED COVERAGE. IF BLOCKOUT DIMENSIONS ARE GREATER THAN RECOMMENDED DIMENSIONS CONTACT YOUR JOINTMASTER REPRESENTATIVE FOR ADDITIONAL HEADER.

CR-S-A02
Compression Seal
 (6' [1.8m] Length Max)

| System | Nominal Width | | Joint Width | | | | H1 Seal Height | | H2 Seal Depth | |
|----------|---------------|-----|-------------|------------|------------|------------|----------------|----|---------------|----|
| | US | mm | Minimum US | Minimum mm | Maximum US | Maximum mm | US | mm | US | mm |
| CR-200 S | 2" | 51 | 1" | 25 | 3" | 75 | 2 3/16" | 56 | 2 5/16" | 59 |
| CR-300 S | 3" | 76 | 1-1/2" | 38 | 4-1/2" | 114 | 3 5/16" | 84 | 3 7/16" | 87 |
| CR-400 S | 4" | 101 | 2" | 51 | 6" | 152 | 3 5/16" | 84 | 3 7/16" | 87 |

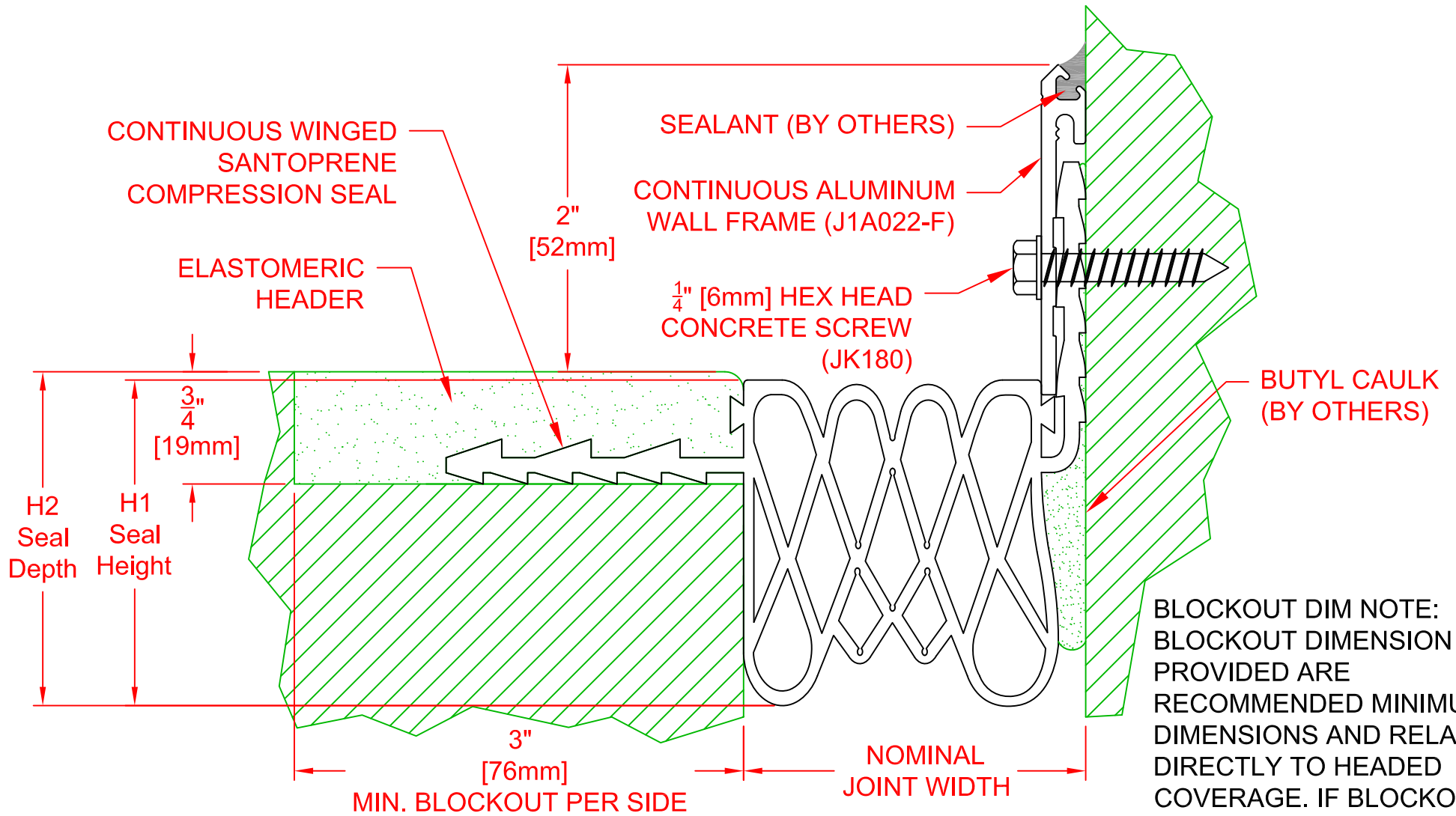

BLOCKOUT DIM NOTE:
 BLOCKOUT DIMENSION PROVIDED ARE RECOMMENDED MINIMUM DIMENSIONS AND RELATE DIRECTLY TO HEADED COVERAGE. IF BLOCKOUT DIMENSIONS ARE GREATER THAN RECOMMENDED DIMENSIONS CONTACT YOUR JOINTMASTER REPRESENTATIVE FOR ADDITIONAL HEADER.

CR-S-A02
Compression Seal
 (6' [1.8m] Length or More)

| System | Nominal Width | | Joint Width | | | | H1 Seal Height | | H2 Seal Depth | |
|----------|---------------|-----|-------------|------------|------------|------------|----------------|----|---------------|----|
| | US | mm | Minimum US | Minimum mm | Maximum US | Maximum mm | US | mm | US | mm |
| CR-200 S | 2" | 51 | 1" | 25 | 3" | 75 | 2 3/16" | 56 | 2 5/16" | 59 |
| CR-300 S | 3" | 76 | 1-1/2" | 38 | 4-1/2" | 114 | 3 5/16" | 84 | 3 7/16" | 87 |
| CR-400 S | 4" | 101 | 2" | 51 | 6" | 152 | 3 5/16" | 84 | 3 7/16" | 87 |

JOINTMASTER™
 EXPANSION JOINT SYSTEMS

DATE: 2/1/17
 SCALE: NTS
 DOC: CADJM.186/rev.2

Application-
 Architectural Compression Seal
 Exterior/Open Structure

PROJECT:
 CUSTOMER:
 LOCATION:

