

- NOTES:
1. COMPARE AMBIENT TEMPERATURE CHARTS WITHIN INSTALLATION INSTRUCTIONS AGAINST JOINT DIMENSIONS IN THE FIELD PRIOR TO ORDERING PRODUCT.
 2. BLOCKOUT DIMENSIONS PROVIDED CORRELATE TO HEADER COVERAGE. IF FIELD CONDITIONS DIFFER- CONTACT YOUR JOINTMASTER REPRESENTATIVE .

SYSTEM	NOMINAL JOINT WIDTH INSTALL RANGE		THERMAL MAXIMUM JOINT WIDTH		SEISMIC MAXIMUM JOINT WIDTH		LATERAL SHEAR TOTAL ABILITY ±		H1 SEAL HEIGHT		H2 INSTALLED DEPTH	
	US	mm	US	mm	US	mm	US	mm	US	mm	US	mm
CR-200S	1 5/8"-2 3/8"	41-60	2 1/2"	64	3"	75	1"	25	2 3/16"	56	2 3/8"	60

FINISH: N/A
PROJECT:
CUSTOMER:
LOCATION:

APPLICATION -
ARCHITECTURAL COMPRESSION SEAL - EXTERIOR/OPEN STRUCTURE

DATE:	2/1/17
SCALE:	NTS
DOC:	CADJM.186/R3

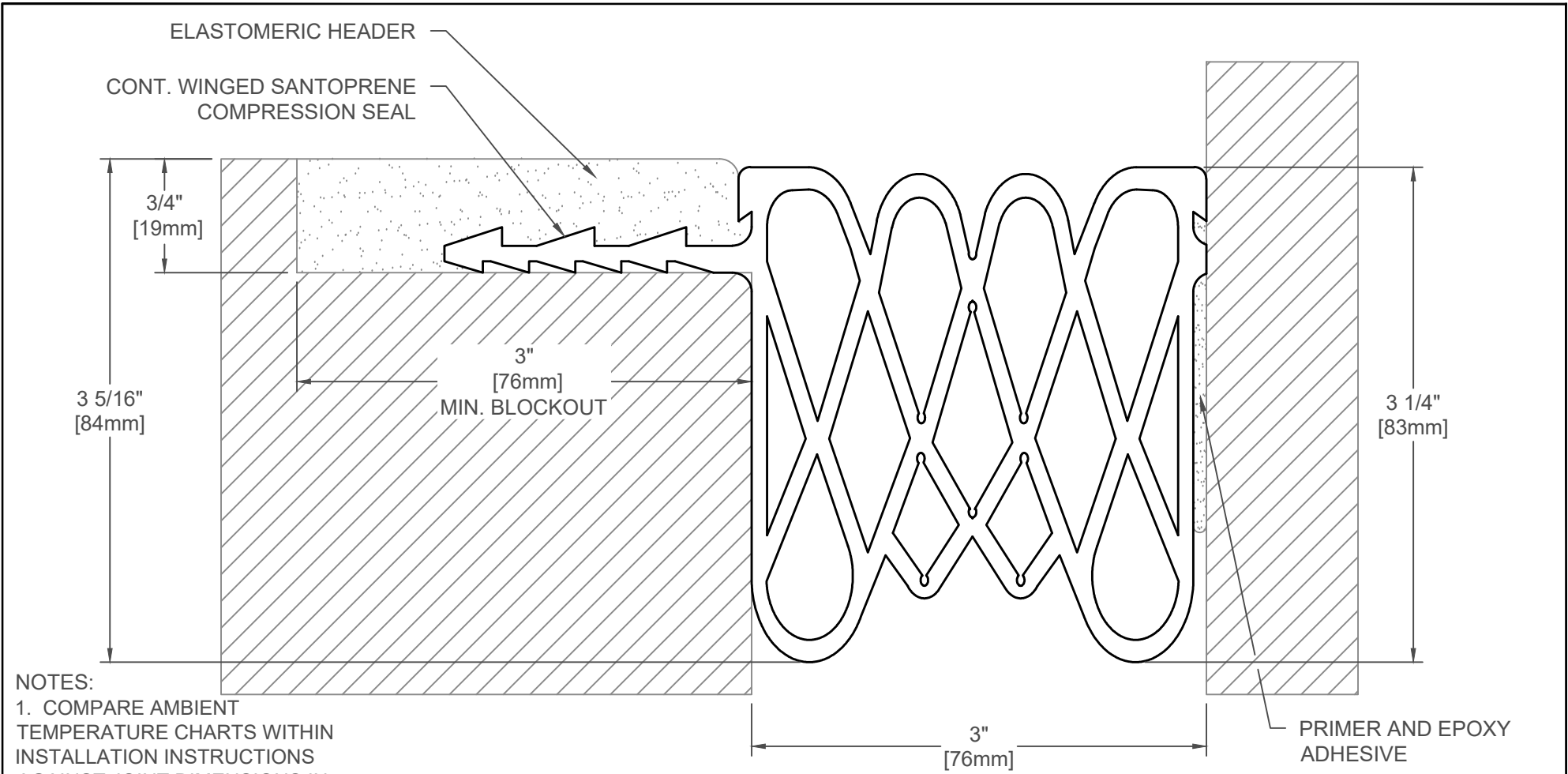

- NOTES:
1. COMPARE AMBIENT TEMPERATURE CHARTS WITHIN INSTALLATION INSTRUCTIONS AGAINST JOINT DIMENSIONS IN THE FIELD PRIOR TO ORDERING PRODUCT.
 2. BLOCKOUT DIMENSIONS PROVIDED CORRELATE TO HEADER COVERAGE. IF FIELD CONDITIONS DIFFER- CONTACT YOUR JOINTMASTER REPRESENTATIVE .

SYSTEM	NOMINAL JOINT WIDTH INSTALL RANGE		THERMAL MAXIMUM JOINT WIDTH		SEISMIC MAXIMUM JOINT WIDTH		LATERAL SHEAR TOTAL ABILITY ±		H1 SEAL HEIGHT		H2 INSTALLED DEPTH	
	US	mm	US	mm	US	mm	US	mm	US	mm	US	mm
CR-300S	2 1/2"-3 3/8"	63-86	3 3/4"	95	4 1/2"	114	1 1/2"	38	3 5/16"	84	3 1/2"	89

FINISH: N/A

PROJECT:

CUSTOMER:

LOCATION:

APPLICATION -
ARCHITECTURAL COMPRESSION SEAL - EXTERIOR/OPEN STRUCTURE

DATE: 2/1/17

SCALE: NTS

DOC: CADJM.186/R3



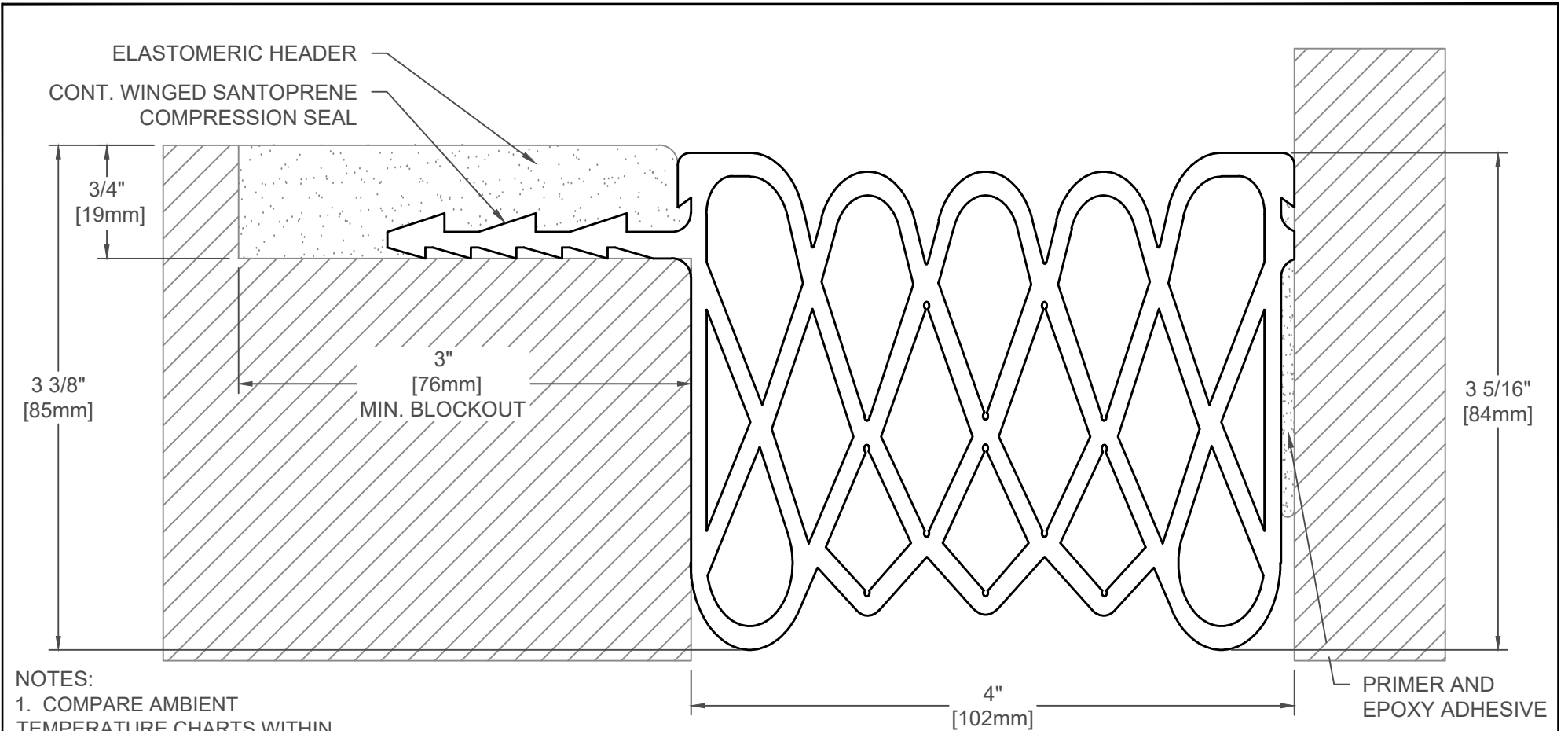

- NOTES:
1. COMPARE AMBIENT TEMPERATURE CHARTS WITHIN INSTALLATION INSTRUCTIONS AGAINST JOINT DIMENSIONS IN THE FIELD PRIOR TO ORDERING PRODUCT.
 2. BLOCKOUT DIMENSIONS PROVIDED CORRELATE TO HEADER COVERAGE. IF FIELD CONDITIONS DIFFER- CONTACT YOUR JOINTMASTER REPRESENTATIVE .

SYSTEM	NOMINAL JOINT WIDTH INSTALL RANGE		THERMAL MAXIMUM JOINT WIDTH		SEISMIC MAXIMUM JOINT WIDTH		LATERAL SHEAR TOTAL ABILITY ±		H1 SEAL HEIGHT		H2 INSTALLED DEPTH	
	US	mm	US	mm	US	mm	US	mm	US	mm	US	mm
CR-400S	3 1/2"-4 3/8"	89-111	5"	127	6"	152	2"	51	3 5/16"	84	3 1/2"	89

FINISH: N/A

PROJECT:

CUSTOMER:

LOCATION:

APPLICATION - ARCHITECTURAL COMPRESSION SEAL - EXTERIOR/OPEN STRUCTURE

DATE: 2/1/17

SCALE: NTS

DOC: CADJM.186/R3



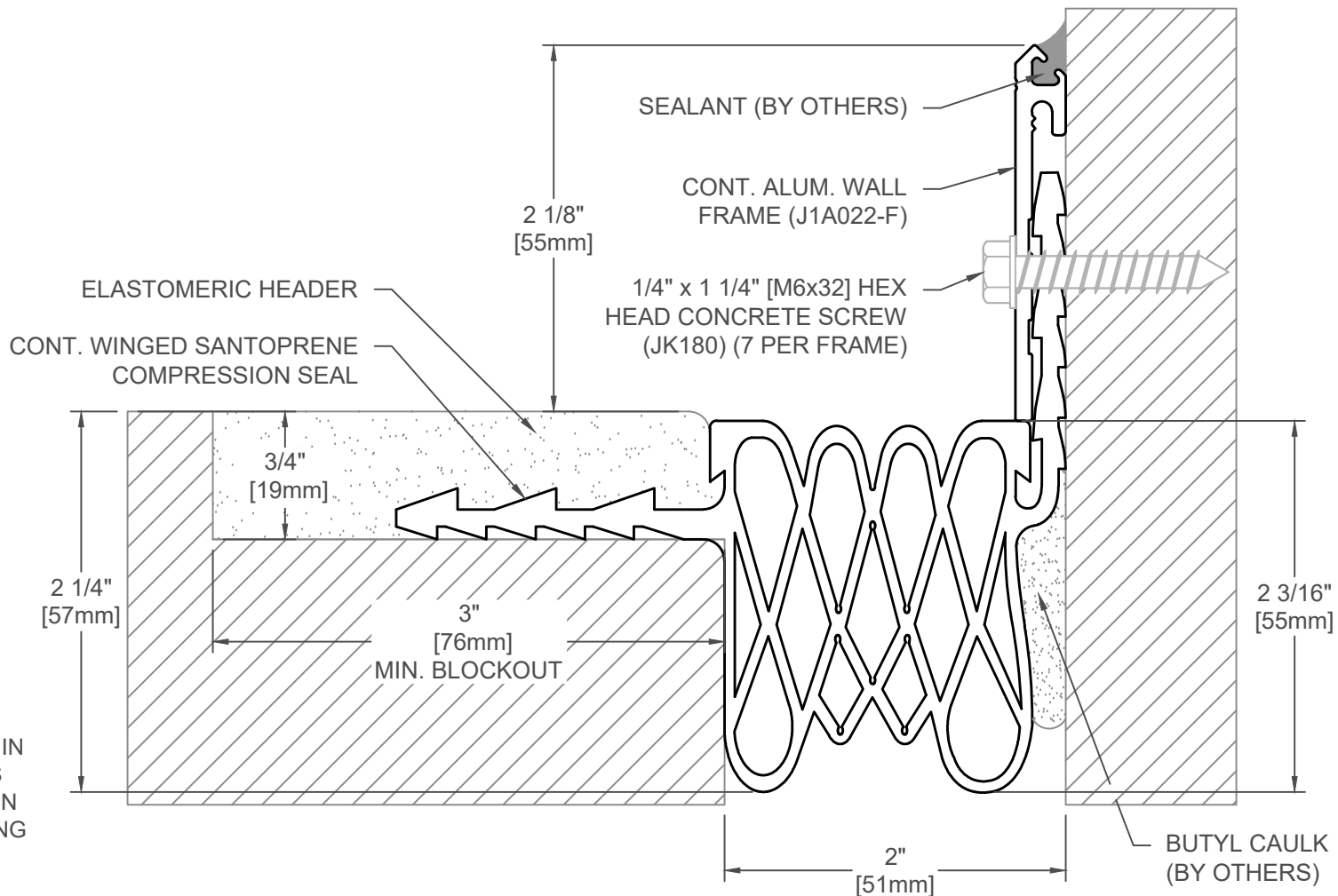

- NOTES:
1. COMPARE AMBIENT TEMPERATURE CHARTS WITHIN INSTALLATION INSTRUCTIONS AGAINST JOINT DIMENSIONS IN THE FIELD PRIOR TO ORDERING PRODUCT.
 2. BLOCKOUT DIMENSIONS PROVIDED CORRELATE TO HEADER COVERAGE. IF FIELD CONDITIONS DIFFER- CONTACT YOUR JOINTMASTER REPRESENTATIVE .

SYSTEM	NOMINAL JOINT WIDTH INSTALL RANGE		THERMAL MAXIMUM JOINT WIDTH		SEISMIC MAXIMUM JOINT WIDTH		LATERAL SHEAR TOTAL ABILITY ±		H1 SEAL HEIGHT		H2 INSTALLED DEPTH	
	US	mm	US	mm	US	mm	US	mm	US	mm	US	mm
CR-200S	1 5/8"-2 3/8"	41-60	2 1/2"	64	3"	75	1"	25	2 3/16"	56	2 3/8"	60

FINISH: N/A

PROJECT:

CUSTOMER:

LOCATION:

APPLICATION -
ARCHITECTURAL COMPRESSION SEAL - EXTERIOR/OPEN STRUCTURE

DATE: 2/1/17

SCALE: NTS

DOC: CADJM.186/R3



For More Information Visit: Inprocorp.com

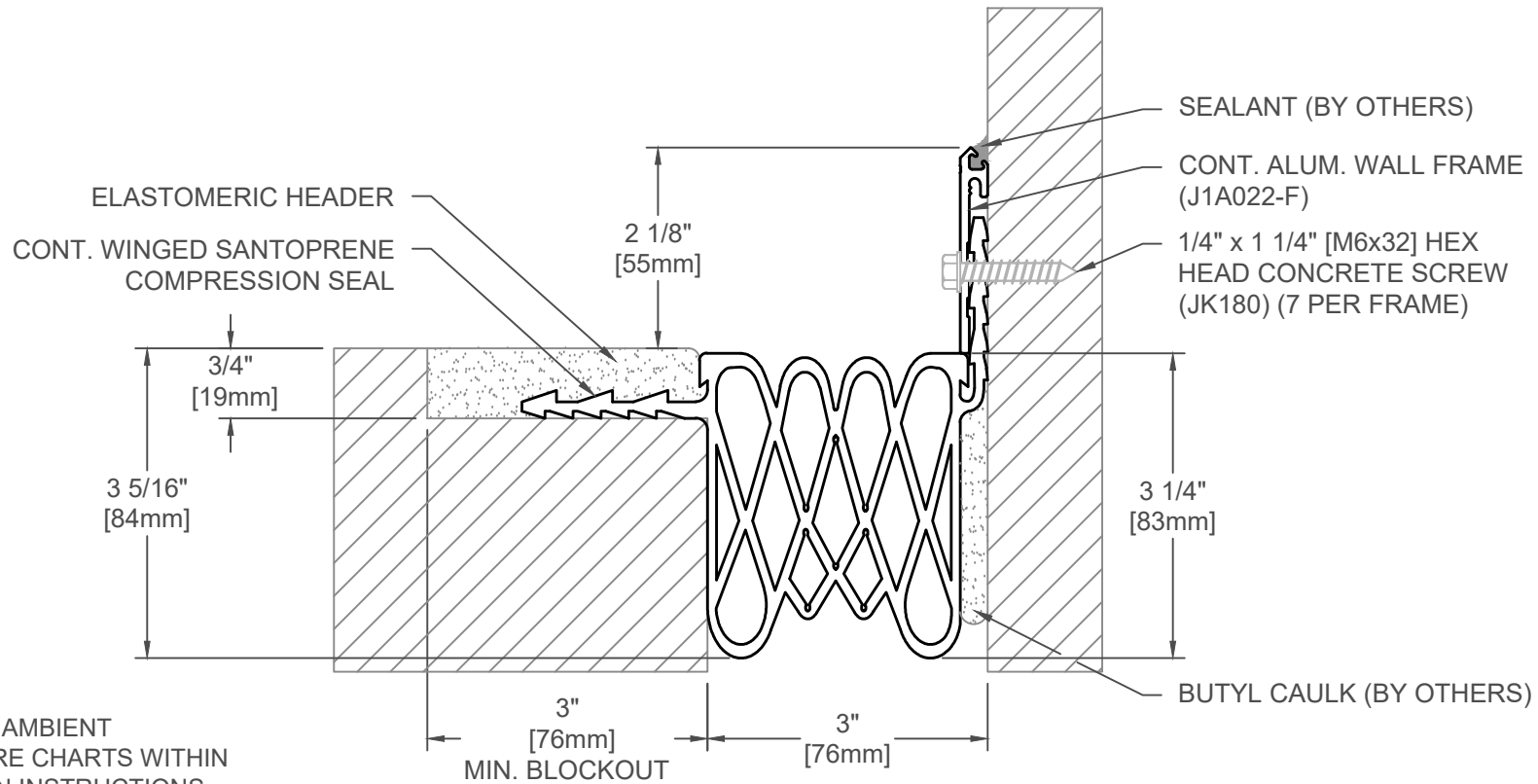

- NOTES:
1. COMPARE AMBIENT TEMPERATURE CHARTS WITHIN INSTALLATION INSTRUCTIONS AGAINST JOINT DIMENSIONS IN THE FIELD PRIOR TO ORDERING PRODUCT.
 2. BLOCKOUT DIMENSIONS PROVIDED CORRELATE TO HEADER COVERAGE. IF FIELD CONDITIONS DIFFER- CONTACT YOUR JOINTMASTER REPRESENTATIVE .

SYSTEM	NOMINAL JOINT WIDTH INSTALL RANGE		THERMAL MAXIMUM JOINT WIDTH		SEISMIC MAXIMUM JOINT WIDTH		LATERAL SHEAR TOTAL ABILITY ±		H1 SEAL HEIGHT		H2 INSTALLED DEPTH	
	US	mm	US	mm	US	mm	US	mm	US	mm	US	mm
CR-300S	2 1/2"-3 3/8"	63-86	3 3/4"	95	4 1/2"	114	1 1/2"	38	3 5/16"	84	3 1/2"	89

FINISH: N/A
PROJECT:
CUSTOMER:
LOCATION:

APPLICATION -
ARCHITECTURAL COMPRESSION SEAL - EXTERIOR/OPEN STRUCTURE

DATE:	2/1/17
SCALE:	NTS
DOC:	CADJM.186/R3

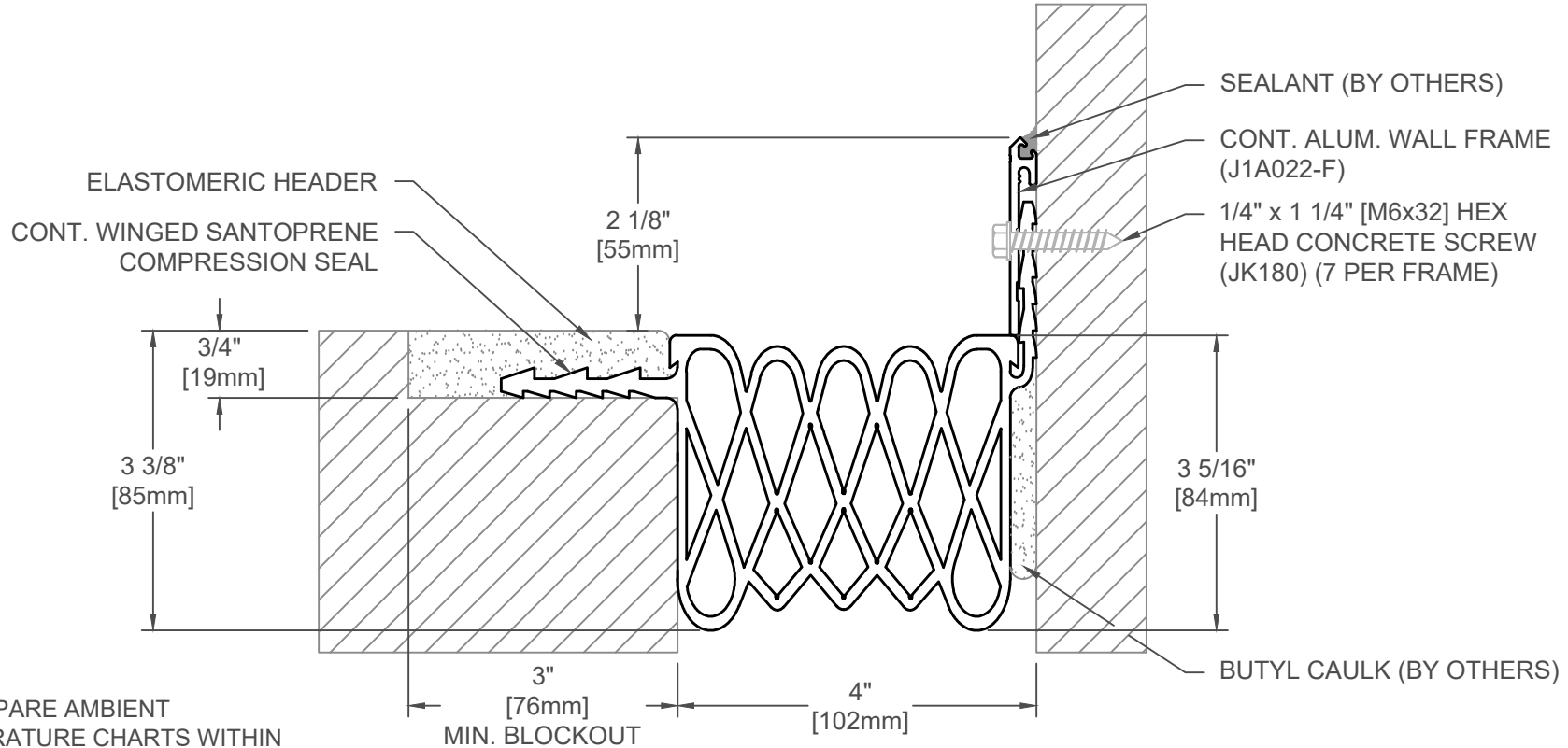

- NOTES:
1. COMPARE AMBIENT TEMPERATURE CHARTS WITHIN INSTALLATION INSTRUCTIONS AGAINST JOINT DIMENSIONS IN THE FIELD PRIOR TO ORDERING PRODUCT.
 2. BLOCKOUT DIMENSIONS PROVIDED CORRELATE TO HEADER COVERAGE. IF FIELD CONDITIONS DIFFER- CONTACT YOUR JOINTMASTER REPRESENTATIVE .

SYSTEM	NOMINAL JOINT WIDTH INSTALL RANGE		THERMAL MAXIMUM JOINT WIDTH		SEISMIC MAXIMUM JOINT WIDTH		LATERAL SHEAR TOTAL ABILITY ±		H1 SEAL HEIGHT		H2 INSTALLED DEPTH	
	US	mm	US	mm	US	mm	US	mm	US	mm	US	mm
CR-400S	3 1/2"-4 3/8"	89-111	5"	127	6"	152	2"	51	3 5/16"	84	3 1/2"	89

FINISH: N/A
PROJECT:
CUSTOMER:
LOCATION:

APPLICATION -
ARCHITECTURAL COMPRESSION SEAL - EXTERIOR/OPEN STRUCTURE

DATE:	2/1/17
SCALE:	NTS
DOC:	CADJM.186/R3



For More Information Visit: Inprocorp.com