

Installation Instructions

Insulated Vapor Barrier

Note: Verify that the structural gap and blockout dimension is in conformance with submittal data before beginning installation. If this is a Fire Rated Assembly, the fire barrier must be installed before the Architectural Joint System. Refer to the fire barrier / insulated vapor barrier instructions for specific system installation.

Figure 1

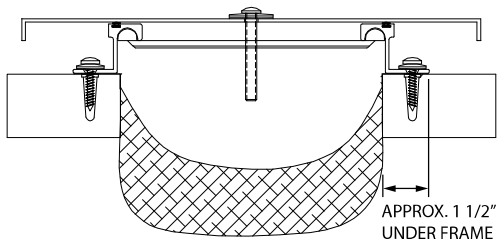

INSTALLED WITH EXPANSION JOINT FRAMES

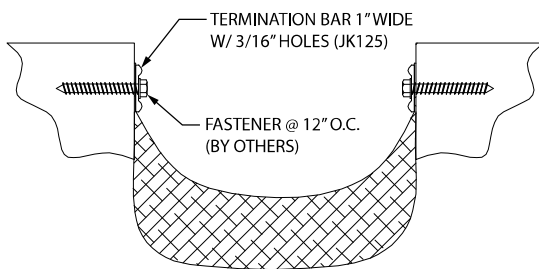

INSTALLED WITH TERMINATION BARS

Figure 2

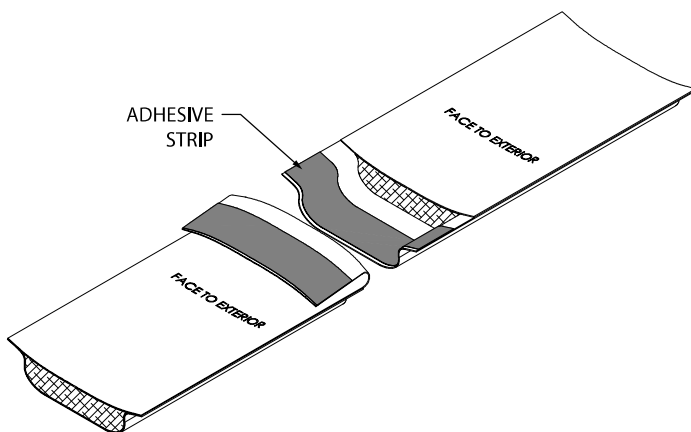

Mounting

Before installing vapor barrier into joint system, pre-assemble section runs remembering to allow for extra length on each end. Clean ends with EPDM primer. (See Fig 2-6)

Figure 1

1. When installing insulated vapor barrier using expansion joint cover frames, place butyl caulk/EPDM tape (by others) against substrate free of dirt, oil and loose debris.

2. When installing insulated vapor barrier with termination bars, Place vapor barrier edges in butyl caulk/tape and secure with termination bar or base of expansion joint cover frame and use appropriate fastener (by others) for substrate.

Seams

Figure 2

3. When butt joining sections together, prepare splicing area with EPDM primer (by others) and allow to dry.

4. Remove film from bottom adhesive strip.

IPC.1097 /REV.4

JOINTMASTER® Expansion Joint Systems

inpro.com • 800.222.5556 • 262.679.9010

World Headquarters S80 W18766 Apollo Drive, Muskego, WI 53150 USA

Installation Hotline: 866.394.6776

inpro®

Installation Instructions

Insulated Vapor Barrier

Figure 3

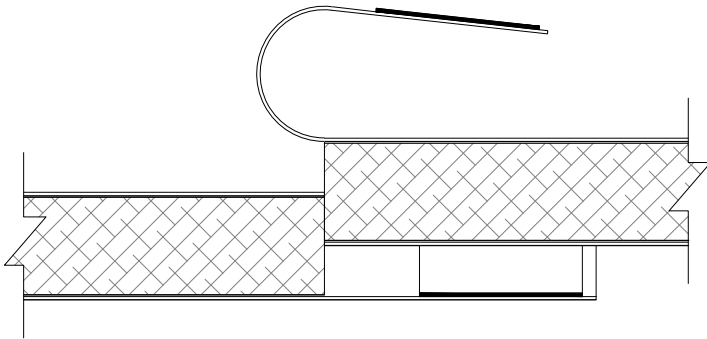

Figure 3

4. Ensure the butt ends of both mating sections are snug against each other.

5. Attach sections together pressing firmly where the adhesive strip attaches to the mating section.

Figure 4

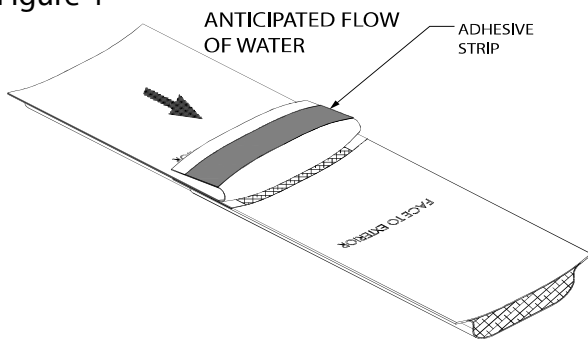
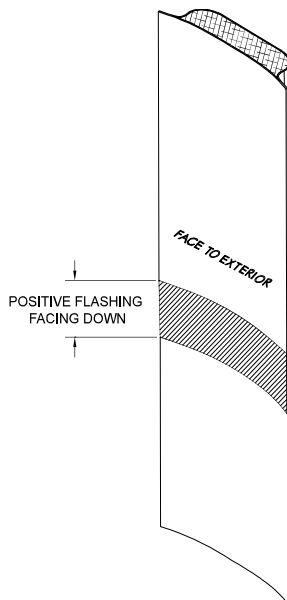

Figure 4

6. Prime surface where adhesive strip will contact EPDM surface.

7. Remove protective coating from adhesive strip on top sheet, and attach to mating section.

8. Once splice is complete, apply pressure with hand roller to area ensuring the adhesive strips are uniformly adhered and form a water tight seal.



Installation Instructions

Insulated Vapor Barrier

Figure 6

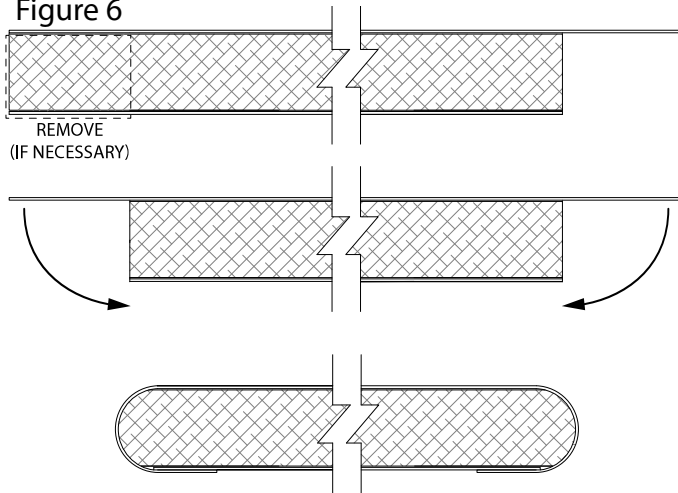

End Caps

Figure 6

9. Once run section is the proper length remove 6" of material from ends underneath the top sheet to create flaps to seal end section.

10. Apply adhesive sealant to underside of flaps and fold over end condition. Seal the flanged edges and any open areas with adhesive to ensure a watertight seal.

Figure 7

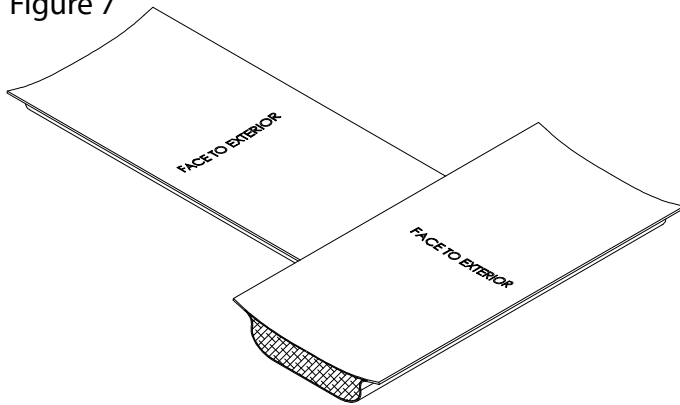

Transitions

Figure 7

11. At intersections, terminate blanket per figure 6. Create butt splice as shown in figure 7.

Figure 8

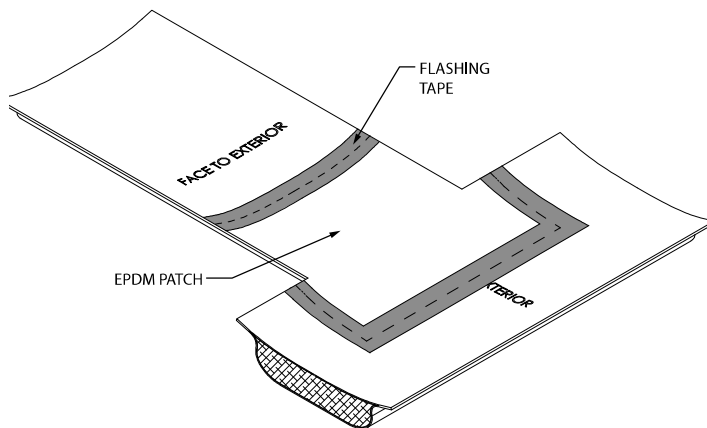

Figure 8

12. Using supplied EPDM sheet, cut a transitional patch which will fit over the entire seam created by the intersection. Ensure EPDM sheet flashing is captured by the frames or termination bar.

13. Apply EPDM patch to the intersection. Overlap seams with flashing tape (by others).

Installation Instructions

Insulated Vapor Barrier

Figure 9

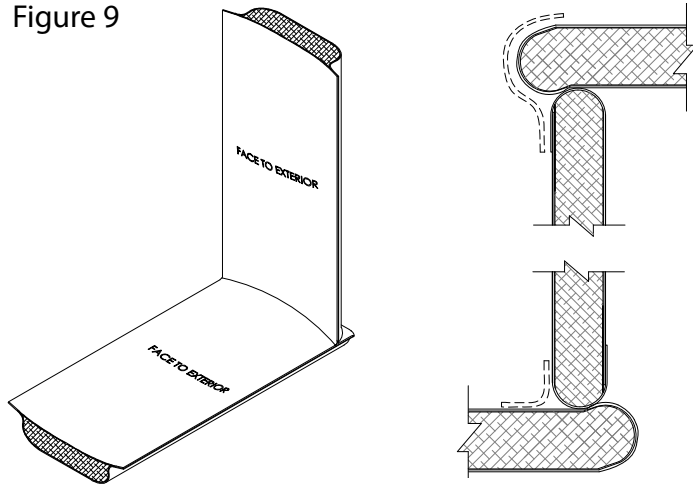

Figure 9

14. At transitions where vertical and horizontal runs intersect, always run the horizontal segment past the vertical segment.

15. Clean with EPDM primer. Install EPDM peel and stick flashing over joint min. 4" (102mm) both directions.

Figure 10

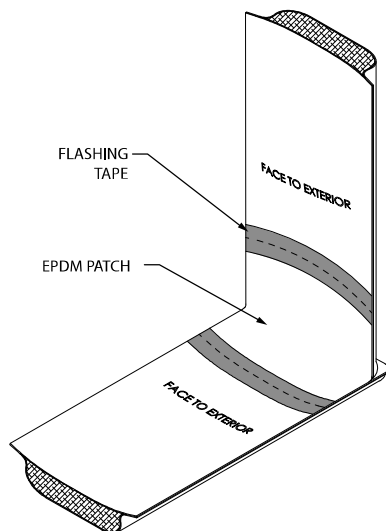

Figure 10

16. Using supplied EPDM sheet, cut a transitional patch which will fit over the entire seam created by the intersection. Ensure EPDM sheet flashing is captured by the frames or termination bar.

17. Attach double stick adhesive to edges of patch and apply to the intersection. Overlap seams with flashing tape.

Installation Instructions

Moisture Barrier Drain System (RVB) - Drain Assembly and Install

Drain System Assembly and Install: (Figure 11)

29. Drains can be installed into moisture barrier before or after horizontal barrier install. It is preferred to install afterward to ensure drain is located perfectly at bottom of membrane drape and at low points of pitched valleys (if applicable).
30. Unscrew black washer and pipe clamp on underside of drain assembly. Identify desired drain location, verifying proper spacing in contract documents. Using a marker, trace the inside of the washer to size the hole appropriately. Cut through both membranes neatly, do not oversize hole.
31. Use EPDM primer and EPDM flashing adhesive, butyl or polyurethane sealant caulk on draped membrane and underside of drain flashing and install. Reference dark shaded area in figure 12 below.
32. On underside of draped membrane, reinstall washer to sandwich the (2) layers of EPDM together. Reinstall the tube and pipe clamp.
33. 2.5' clear vinyl whip is provided. Ultimate termination configuration and tie into building plumbing drainage by others.

Figure 11

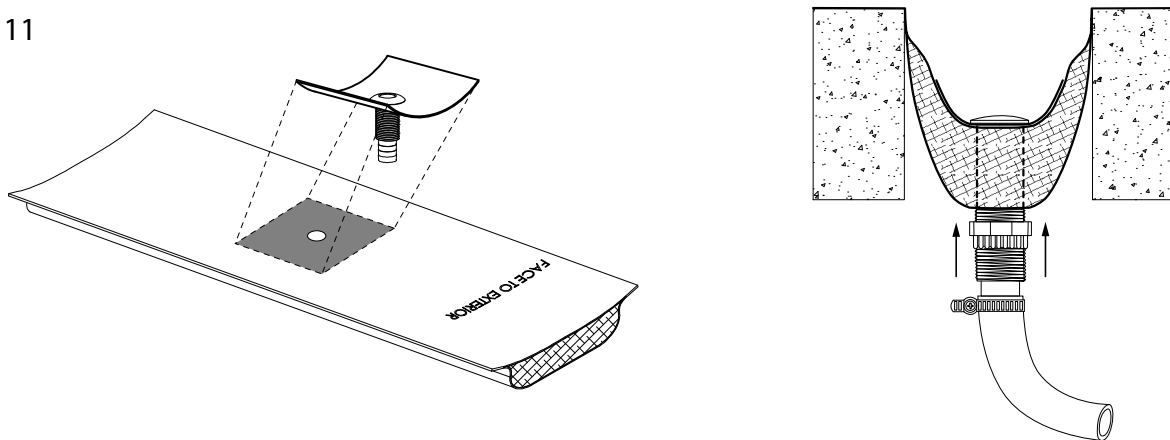

Note: One suggested solution below: (Figure 12)

-Hard line (PVC) drain lines can be installed with vertical sleeves. Insert clear vinyl tube drains into sleeves (minimum of 6"). Do not secure in place, allow tube to rise and fall freely.

Figure 12

