

300 Series

A07 - Wall to Wall or Ceiling to Ceiling

A09 - Wall to Corner or Wall to Ceiling



Movement Rating ± 50%

Product Guide



Interior



Seismic



Fire Rated Option



Vapor Barrier Option

- ▶ 5/8" recessed frame designed for drywall installations or can be surface mounted
- ▶ Clear anodized finish
- ▶ Snap-fit cover design for easy on-site assembly
- ▶ Custom angles available

Application	System	W		H1		H2		S		S1		B		Movement +/-			
		Joint Width		Frame Height 1		Height 2		Sightline		Sightline		Blockout		Horizontal		Vertical	
		US	mm	US	mm	US	mm	US	mm	US	mm	US	mm	US	mm	US	mm
Wall/Wall Ceiling/Ceiling	300-A07-025	1"	25	5/8"	16	*	*	5"	127	*	*	2"	51	1/2"	13	1/4"	6
	300-A07-050	2"	51	5/8"	16	*	*	6"	152	*	*	2"	51	1"	25	1/2"	13
	300-A07-075	3"	76	5/8"	16	*	*	9"	229	*	*	3"	76	1 1/2"	38	3/4"	19
	300-A07-100	4"	102	5/8"	16	*	*	10"	254	*	*	3"	76	2"	51	1"	25
	300-A07-150	6"	152	5/8"	16	*	*	14"	356	*	*	4"	102	3"	76	1 1/2"	38
	300-A07-200	8"	203	5/8"	16	*	*	18"	458	*	*	5"	127	4"	102	2"	51
	300-A07-250	10"	254	5/8"	16	*	*	24"	610	*	*	7"	178	5"	127	2 1/2"	64
	300-A07-300	12"	305	5/8"	16	*	*	26"	661	*	*	7"	178	6"	152	3"	76
Wall/Corner Wall/Ceiling	300-A09-025	1"	25	5/8"	16	*	*	2 3/8"	60	2 1/4"	56	2"	51	1/4"	6	3/4"	19
	300-A09-050	2"	51	5/8"	16	*	*	3 3/8"	85	2 3/4"	70	2"	51	1/2"	13	3/4"	19
	300-A09-075	3"	76	5/8"	16	*	*	5 3/8"	136	2 3/4"	70	3"	76	3/4"	19	7/8"	22
	300-A09-100	4"	102	5/8"	16	*	*	6 3/8"	162	2 3/4"	70	3"	76	1"	25	1"	25
	300-A09-150	6"	152	5/8"	16	*	*	9 7/16"	239	2 3/4"	70	4"	102	1 1/2"	38	1 1/4"	32
	300-A09-200	8"	203	5/8"	16	*	*	12 3/8"	314	2 3/4"	70	5"	127	2"	51	1 1/2"	38
	300-A09-250	10"	254	5/8"	16	*	*	16 3/8"	416	5 1/4"	134	7"	178	2 1/2"	64	2"	51
	300-A09-300	12"	305	5/8"	16	*	*	18 3/8"	466	5 1/4"	134	7"	178	3"	76	2 1/2"	64

May be available in larger widths, please contact InPro Corporation for more details.

IPC.831/REV.12

Inprocorp.com • 800.222.5556 • 262.679.9010
World Headquarters S80 W18766 Apollo Drive, Muskego, WI 53150 USA

JOINTMASTER®
EXPANSION JOINT SYSTEMS
A DIVISION OF INPRO®

300 Series

Wall and Ceiling Systems

300-A07 Wall/Wall
(2" (50mm) system shown)

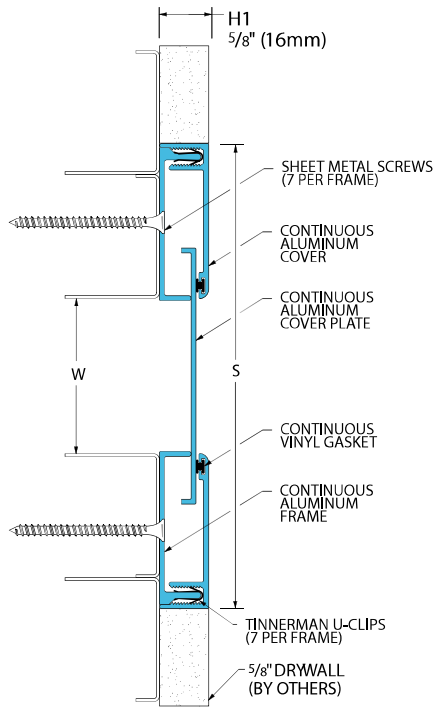

300-A09 Wall/Corner
(2" (50mm) system shown)

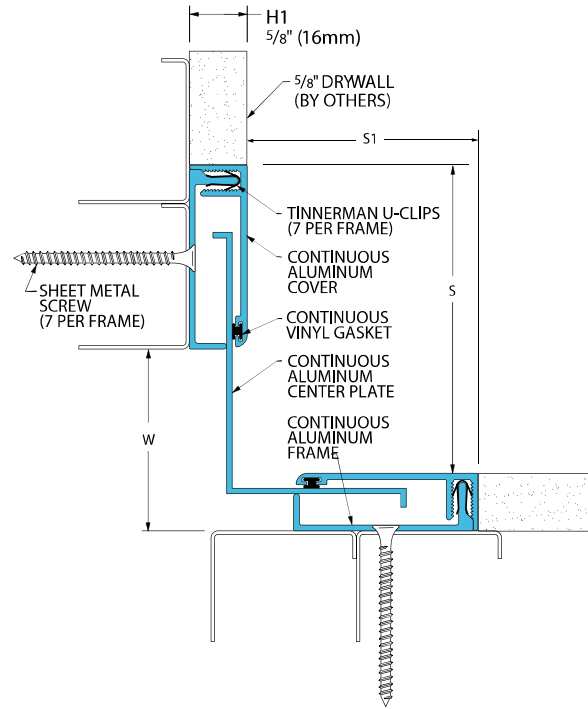

300 Series Options

Fire Blanket System
(300-A07-050 system shown)

